

FIAMM

Industrial Batteries

HIGHLITE FLX series

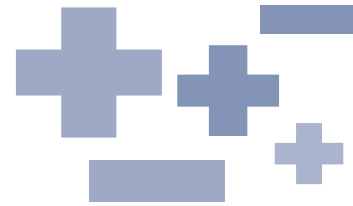

12FLX350

FIAMM's FLX batteries have been specifically designed to achieve optimal performance in:

- + High-Rate UPS Systems
- + Emergency Power Applications

A compact footprint provides easy installation in cabinets and racks with minimal space clearance.

Capable of protecting the critical load from power disturbances.

Standby Products

Product Features

- + High integrity design with superior energy density in industry standard footprint
- + Microporous absorbent glass mat "AGM" technology, low maintenance, 99% recombination, non-spillable
- + 10 year design life @ 25°C
- + UL94V-0 rated flame retardent plastic
- + Gravity cast, high purity, Lead-Tin Calcium grids for low corrosion and high rate performance
- + Individual cell flame arrestors
- + Non-spillable, unrestricted for air/water/surface transport
- + Handles, integrated design, flush mount

Technical Data

BATTERY TYPE	NOMINAL VOLTAGE (V)	CAPACITY at 77°F Watt per Cell 15 mins 1.67V/C	CAPACITY at 77°F (AH) 8 hours 1.75V/C	DIMENSIONS in.			WEIGHT lbs/(kg)	TERMINALS
				Top Length/ Bottom Length	Top Width/ Bottom Width	Top Height/ Bottom Height		
12 FLX 350	12	374	79.2	11.87/11.76	6.85/6.57	8.58	67.5/(30.7)	1/4" - 20

Applicable Standards

Telcordia (Bellcore) SR-4228
 Telcordia (Bellcore) TR-NWT-001200
 Telcordia (Bellcore) TR-NWT-000909
 UL Recognized
 UL 94 Class V-0
 UL 1778
 IEC 60896 Part 21-22

Terminal Type

Torque: 106 in.lbs.

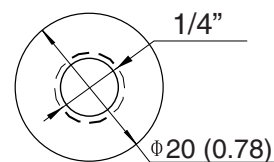

FLX350 DISCHARGE WATTS PER CELL AT 77°F

Volts per Cell	MINUTES						
	30	60	120	180	240	300	480
1.60	204	115	62.3	44.1	34.5	28.9	19.6
1.65	203	114	62.0	43.9	34.4	28.8	19.6
1.67	225	128	61.9	43.8	34.3	28.7	19.5
1.70	199	113	61.7	43.7	34.2	28.7	19.5
1.75	194	111	61.5	43.4	34.1	28.6	19.3

FLX350 DISCHARGE AMPERES AT 77°F

BATTERY TYPE	MINUTES						
	30	60	120	180	240	300	480
1.60	111	62.0	33.1	23.4	18.2	15.2	10.3
1.65	109	60.8	32.7	23.1	18.0	15.0	10.2
1.67	107	60.2	32.4	22.9	17.9	14.9	10.1
1.70	106	59.7	32.3	22.7	17.8	14.9	10.1
1.75	102	57.9	31.8	22.3	17.5	14.7	9.90

Electrical Characteristics

- ✦ FLOAT VOLTAGE CHARGE AT 77°F: 13.62 V/block (13.6 - 13.8)
- ✦ FLOAT VOLTAGE COMPENSATION WITH TEMPERATURE: -8.3 mV/°F per block
- ✦ SELF-DISCHARGE AT 77°F: < 2% / month

